

2010 North Boulder Waterline Replacement

Bid Number 09- 2010

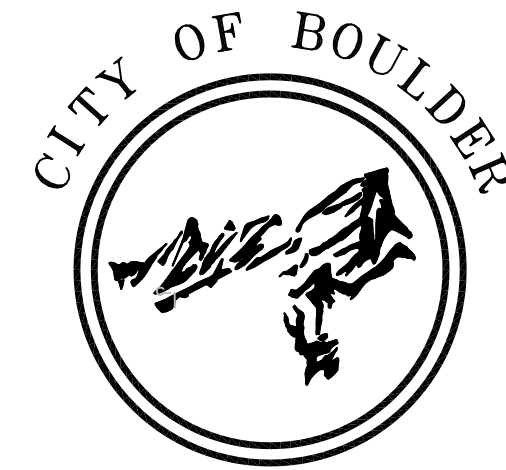

Utilities Division

Project Manager.... John Mellblom

For Further Information Call.....441-3178

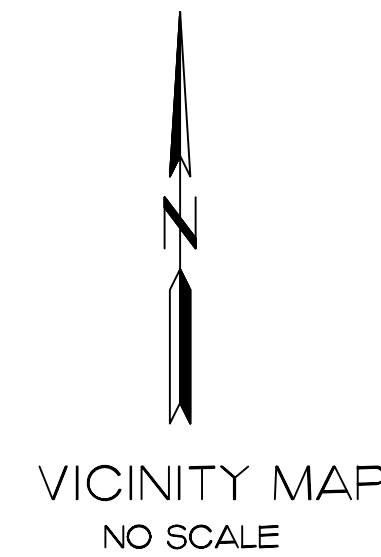

Project Sites

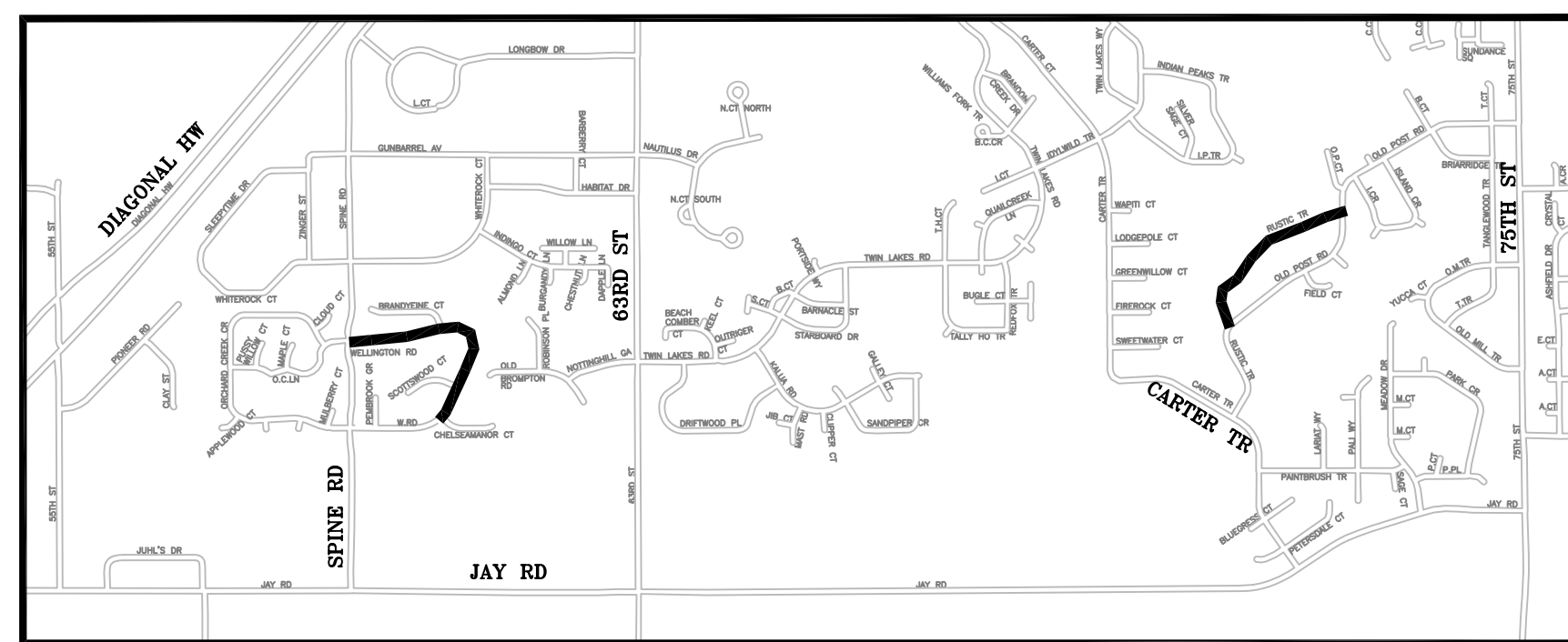
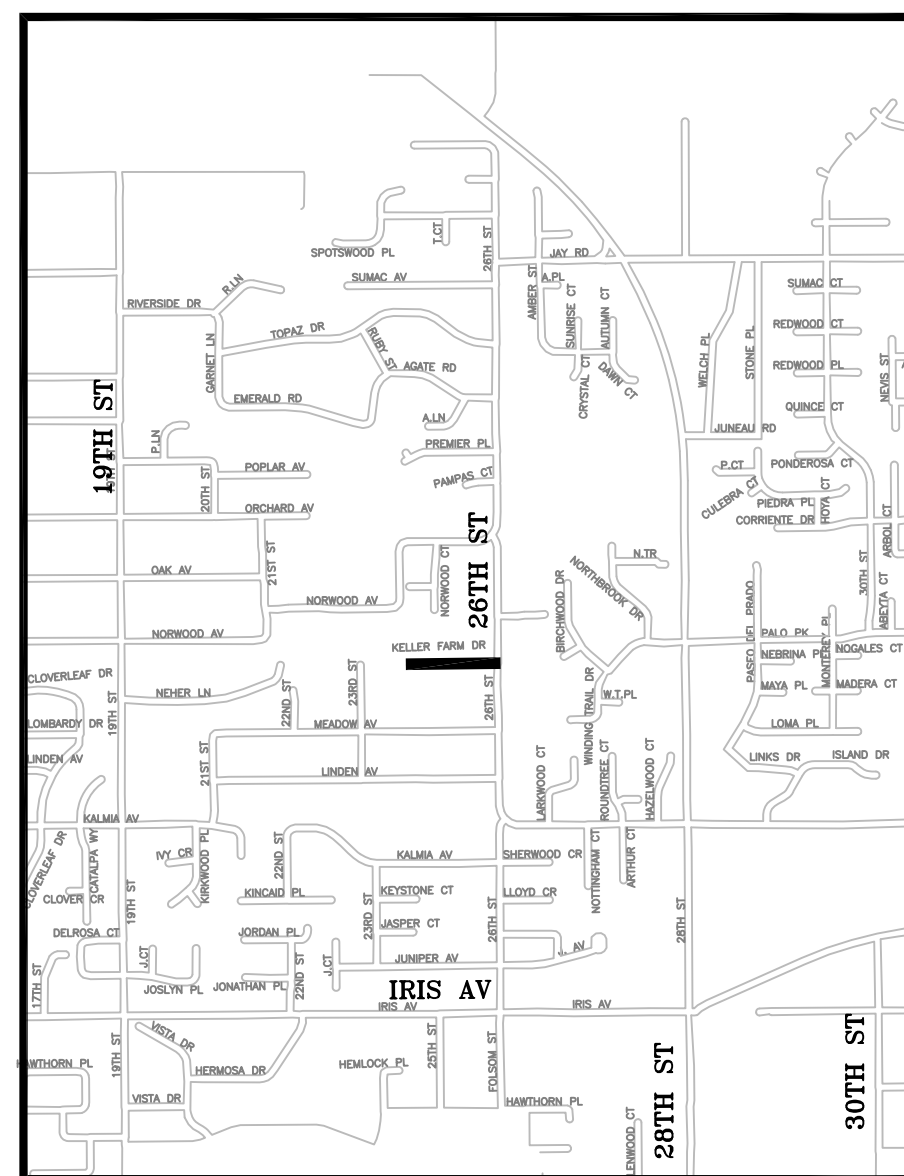
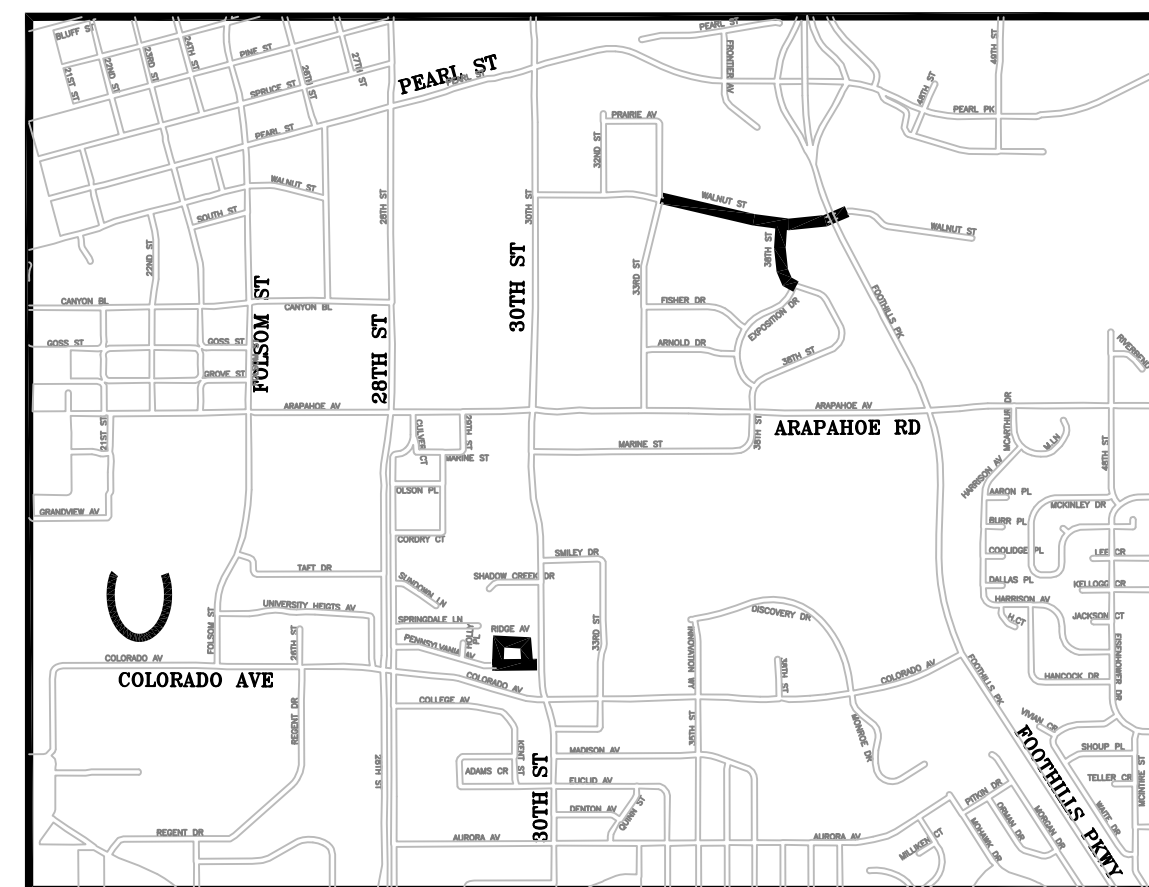

NOTES:

1. The type, size, location and number of all known underground utilities are approximate as shown on the drawings. It shall be the responsibility of the Contractor to verify the existence and location of all underground utilities along the route of Work and to coordinate construction schedules with these utility owners. The Contractor shall note all utilities may not appear on these plans and that the potential conflict with utilities shall be considered in the preparation of cost estimates and bids. The Contractor shall be responsible for protecting utilities during construction and shall hold the City and the Engineer harmless for damages arising from failure to adequately protect utilities. Also, it shall be the responsibility of the Contractor to schedule utility adjustments to eliminate conflict with progress of the Work.
2. All water services are assumed to be 3/4 " unless otherwise noted.
3. All existing gate valves and fire hydrants to be abandoned shall have the valve box and or barrel removed to 6" below finish grade and filled with lean concrete and the surface restored to match the existing conditions.
4. All waterlines shall have a minimum 4.5' cover from finished grade.

SHEET INDEX

1.	TITLE SHEET	13.	RUSTIC TRAIL 0+00-5+00
2.	SHEET INDEX	14.	RUSTIC TRAIL 5+00-10+00
3.	WALNUT 0+00-5+00	15.	RUSTIC TRAIL 10+00-15+22
4.	WALNUT 5+00-10+00	16.	STANDARD DETAILS
5.	WALNUT 10+00-15+00	17.	STANDARD DETAILS
6.	38TH STREET		
7.	WALNUT 0+00-15+00 BID ALT. I SLIP LINING		
8.	EAST RIDGE AVENUE		
9.	KELLER FARM DRIVE		
10.	WELLINGTON ROAD 0+00-5+50		
11.	WELLINGTON ROAD 5+50-12+42		
12.	WELLINGTON ROAD 13+80-16+37		

Legend

- Existing
- W —EXIST WATER & VALVE
 - S —EXIST SAN. SEWER & MANHOLE
 - ST —EXIST STORM SEWER & MANHOLE
 - G —GAS
 - FO —FIBER OPTIC
 - TELE —TELEPHONE
 - OHU —OVERHEAD UTILITY
 - TRAF —TRAFFIC LOOP DETECTOR LINE
 - ⊕/⊗EXIST. ELECTRIC / TELEPHONE MANHOLE
 -MONITOR WELL
 - ▨ELECTRIC BOX
 - ⊗GATE VALVE
 - △SURVEY CONTROL POINT
 - ⊕SURVEY MONUMENT BOX
 - ⊠EXIST INLET
 - ⊕FIRE HYDRANT
 - ⊗WATER METER
 - ⊗IRRIGATION CONTROL VALVE
 - ⊙UTILITY POLE
 - ☆LIGHT POLE
 - ⊗TRAFFIC SIGNAL POLE/LIGHT POLE
 - ⊠TRAFFIC CONTROL CABINET
 - ⊗/⊗TRAFFIC SIGNAL BOX
 - ⊙DECIDUOUS TREE
 - ⊙EVERGREEN TREE
 - ⊙IRRIGATION
- Proposed
- + —NEW WATER + VALVE
 - ⊕NEW FIRE HYDRANT
 - ⊕NEW TEE
 - △THRUST BLOCK
 - ▶REDUCER
 - ▨SANITARY SEWER CROSSING
 - ▨CASING PIPE

CITY OF BOULDER, COLORADO

DESIGNED: JWM
DRAWN: JWM/CSM
CHECKED: RE
DATE: 03/10

PROJECT NO.: 09-2010
SURVEYED BY: BLC
CHECKED: DATE:
PROJECT ENGINEER: JOHN MELLBLOM

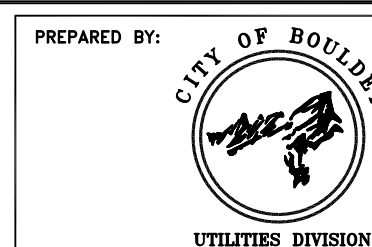

DATE	REVISIONS	BY

2010 WATERLINE REPLACEMENT

FILE TITLE_IO
SHEET 1
17