

BROADWAY - PINE TO IRIS

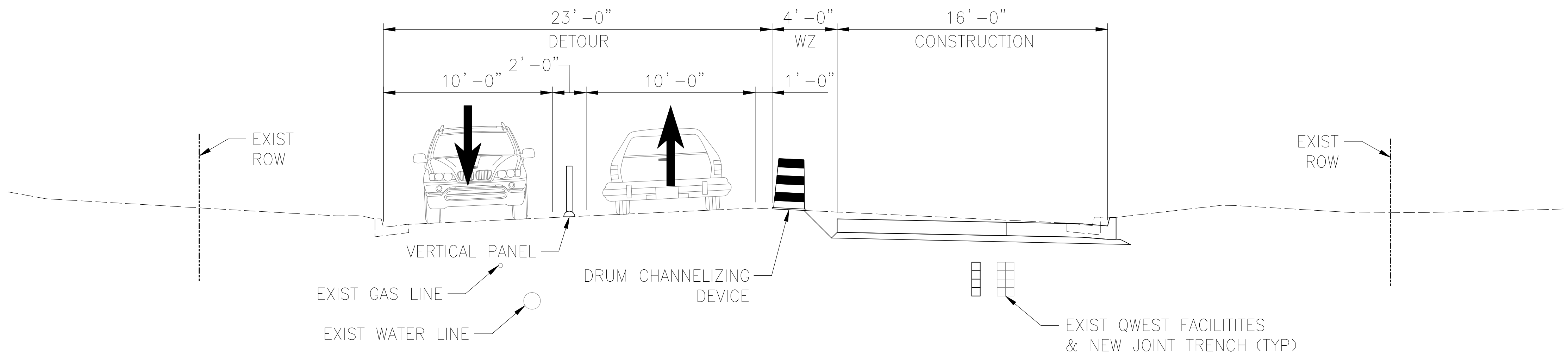

TYPICAL FOUR LANE DETOUR SECTION - PHASE 1

SHIFT ONE LANE OF TRAFFIC IN EACH DIRECTION TO THE WEST SIDE OF BROADWAY
INSTALL UTILITIES ALONG THE EAST SIDE OF BROADWAY FOLLOWED BY 16' OF CONCRETE PAVEMENT

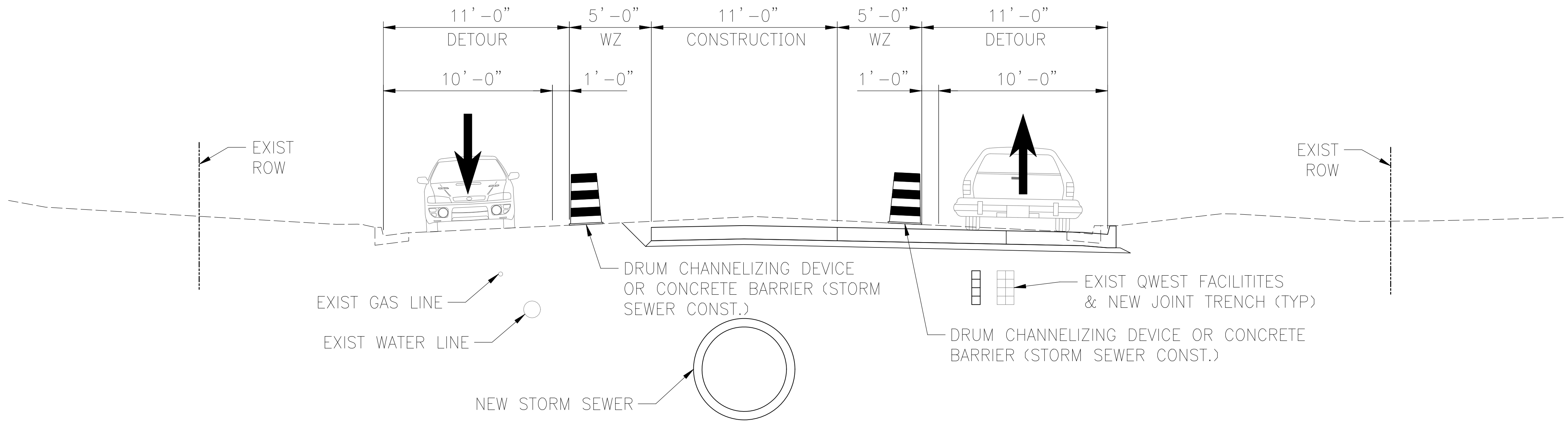

TYPICAL FOUR LANE DETOUR SECTION - PHASE 2

SHIFT NORTHBOUND TRAFFIC TO THE EAST SIDE OF BROADWAY
INSTALL UTILITIES DOWN THE CENTER OF BROADWAY FOLLOWED BY 11' OF CONCRETE PAVEMENT

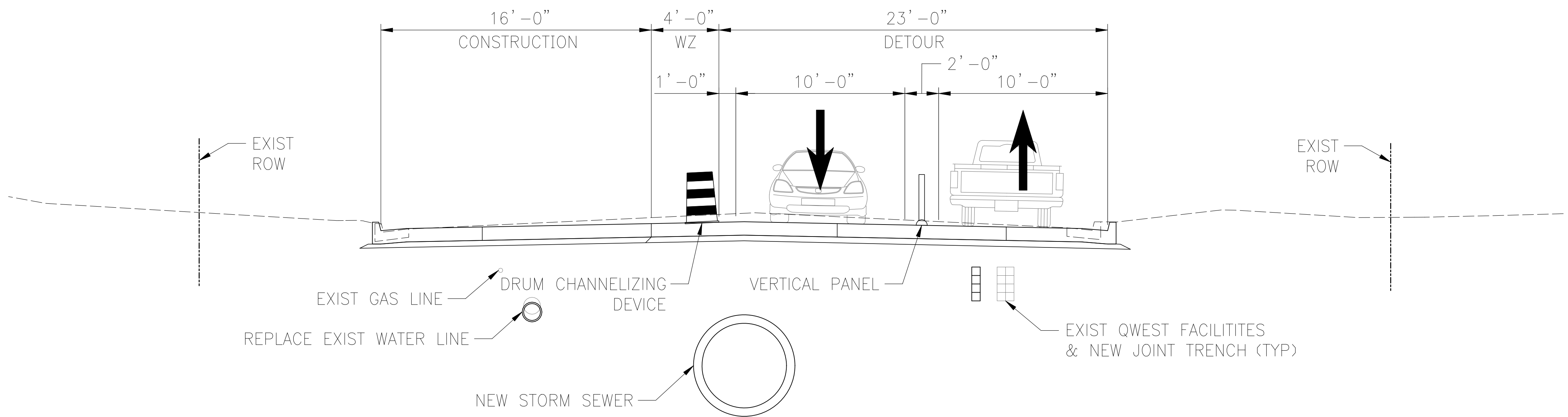

TYPICAL FOUR LANE DETOUR SECTION - PHASE 3

SHIFT SOUTHBOUND TRAFFIC TO THE EAST SIDE OF BROADWAY
INSTALL UTILITIES ALONG THE WEST SIDE OF BROADWAY FOLLOWED BY 16' OF CONCRETE PAVEMENT

